



Aeronautical Information Services Emails:

[aisckia@caymanairports.com](mailto:aisckia@caymanairports.com)

[aisoria@caymanairports.com](mailto:aisoria@caymanairports.com)

Phones: 1345-244-5852 (CKIA)

1345-244-5827 (ORIA)

**IAIP AMDT 01/2023**

**18 MAY 2023**

---

**THIS AMENDMENT *SHOULD NOT* BE INSERTED INTO THE AIP UNTIL 18 MAY 2023.  
HOWEVER, PLEASE REVIEW THE CONTENTS BEFORE THE EFFECTIVE DATE.**

This amendment includes changes to information of permanent nature contained in the AIP/Cayman Islands.

**INSERT:**

**GEN 0**

0.2-1 RECORD OF AIP AMENDMENT UPDATED- 18 MAY 2023

0.4-1 CHECKLIST OF PAGE UPDATED- 18 MAY 2023

0.4-2 CHECKLIST OF PAGE UPDATED – 18 MAY 2023

**GEN 1**

1.2-2 PROCEDURES UPDATED- 18 MAY 2023

1.2-3 ADVANCE NOTIFICATION OF ARRIVAL UPDATED -18 MAY 2023

**GEN 2**

2.1-2 PUBLIC HOLIDAY 2023 – 18 MAY 2023

**ENR 5**

ENR 5.3 OTHER ACTIVITIES OF A DANGEROUS NATURE AND  
OTHER POTENTIAL HAZARDS UPDATED – 18 MAY 2023

**AD 2**

2-14- AD 2.23 ADDITIONAL INFORMATION UPDATED – 18 MAY 2023

2-16-- AERODROME CHART CHARLES KIRKCONNELL UPDATED -18 MAY 2023

2-42- AERODROME CHART OWEN ROBERTS INTERNATIONAL UPDATED- 18 MAY 2023

2-43 AIRCRAFT PARKING AND DOCKING CHART UPDATED- 18 MAY 2023

2-44 AERODROME OBSTACLE CHART UPDATED- 18 MAY 2023

**DESTROY:**

**GEN 0**

0.2-1 - 11 AUG 2022

0.4-1 - 11 AUG 2022

0.4-2 - 11 AUG 2022

**GEN 1**

1.2-2 -25 MAR 2021

1.2-3 -08 OCT 2020

**GEN 2**

2.1-2 -24 FEB 2022

**ENR 5**

5.3 - 01 JAN 2001

**AD 2**

AD 2-14-11 AUG 2022

AD 2-16- 11 AUG 2022

AD 2-42- 24 FEB 2022

AD 2-43- 09 SEPT 2021

AD 2-44 - 24 FEB 2022

## GEN 0.2 RECORD OF AIP AMENDMENTS

AIP AMENDMENTS			
<i>NR/Year</i>	<i>Publication date</i>	<i>Date inserted</i>	<i>Inserted by</i>
01/2001	05/03/01	05/03/01	WE
02/2001	25/06/01	25/06/01	WE
03/2001	01/09/01	01/09/01	WE
04/2001	27/12/01	27/12/01	WE
05/2002	19/08/02	19/08/02	WE
06/2003	20/02/03	20/02/03	WE
07/2003	27/12/03	27/12/03	WE
08/2005	17/02/05	17/02/05	WE
09/2005	22/07/05	22/07/05	WE
10/2006	31/01/06	31/01/06	WE
11/2006	28/09/06	28/09/06	WE
12/2006	26/10/06	26/10/06	WE
13/2009	27/08/09	27/08/09	WE
14/2010	13/01/11	13/01/11	WE
15/2012	26/07/12	26/07/12	WE
16/2012	15/11/12	15/11/12	WE
17/2013	07/02/13	07/02/13	WE
18/2013	22/08/13	22/09/13	WE
19/2014	06/02/14	06/02/14	RMH
20/2014	03/04/14	03/04/14	RMH
21/2014	21/08/14	21/08/14	RMH
22/2015	20/08/15	20/08/15	FS
23/2015	15/10/15	15/10/15	FS
24/2016	08/12/16	08/12/16	GP

AIP AMENDMENTS			
<i>NR/Year</i>	<i>Publication date</i>	<i>Date inserted</i>	<i>Inserted by</i>
25/2017	02/03/17	31/03/17	GP
26/2017	31/03/17	26/05/17	GP
27/2017	07/12/17	04/01/18	GP
01/2018	01/02/18	07/03/18	GP
02/2018	26/04/18	30/08/18	GP
01/2019	28/02/19	28/03/19	GP
01/2020	28/03/20	23/04/20	GP
02/2020	09/09/20	08/10/20	GP
03/2020	08/11/20	02/12/20	GP
01/2021	31/12/20	28/01/21	GP
02/2021	25/02/21	25/03/21	GP
03/2021	15/07/21	09/09/21	GP
01/2022	27/01/2022	24/02/22	GP
02/2022	24/03/2022	21/04/22	GP
03/2022	22/06/2022	11/08/22	GP
01/2023	16/04/2023	18/05/2023	GP

**CHECKLIST OF PAGES**

<b>PART 1 GENERAL (GEN)</b>		<b>PART 1 GENERAL (GEN)</b>		<b>PART 2- EN-ROUTE(ENR)</b>	
<b>GEN 0</b>		<b>GEN 2 (CONTINUED)</b>		<b>ENR 0</b>	
<b>Page</b>	<b>Date</b>	<b>Page</b>	<b>Date</b>	<b>Page</b>	<b>Date</b>
0.1-1	28 FEB 06	2.3-1	27 AUG 09	0.6-1	01 JAN 01
0.1-2	28 FEB 06	2.3-2	27 AUG 09	0.6-2	01 JAN 01
0.1-3	28 MAR 19	2.3-3	27 AUG 09	0.6-3	01 JAN 01
0.1-4	01 JAN 01	2.3-4	27 AUG 09	<b>ENR 1</b>	
0.2-1	18 MAY 2023	2.3-5	27 AUG 09	1.1-1	01 JAN 01
0.2-2	26 MAY 17	2.3-6	27 AUG 09	1.2-1	01 JAN 01
0.3-1	12 NOV 15	2.3-7	27 AUG 09	1.2-2	01 JAN 01
0.4-1	18 MAY 2023	2.4-1	28 JAN 2021	1.3-1	01 JAN 01
0.4-2	18 MAY 2023	2.5-1	09 SEPT 2021	1.3-2	01 JAN 01
0.4-3	02 DEC 2020	2.6-1	01 JAN 01	1.4-1	01 JAN 01
0.5-1	01 JAN 01	2.6-2	01 JAN 01	1.4-2	01 JAN 01
0.6-1	01 JAN 01	2.7-1	23 APR 2020	1.5-1	06 FEB 14
0.6-2	01 JAN 01	<b>GEN 3</b>		1.6-1	01 JAN 01
0.6-3	01 JAN 01	3.1-1	28 JAN 2021	1.7-1	01 JAN 01
0.6-4	01 JAN 01	3.1-2	28 JAN 2021	1.7-2	01 JAN 01
<b>GEN 1</b>		3.1-3	28 JAN 2021	1.7-3	01 JAN 01
1.1-1	25 MAR 2021	3.1-4	28 JAN 2021	1.8-1	01 JAN 01
1.1-2	04 JAN 18	3.1-5	09 SEPT 2021	1.9-1	01 JAN 01
1.2-1	25 MAR 2021	3.2-1	21 APR 2022	1.10-1	25 MAR 2021
1.2-2	18 MAY 2023	3.2-2	28 JAN 2021	1.10-2	25 MAR 2021
1.2-3	18 MAY 2023	3.2-3	20 AUG 15	1.10-3	28 JAN 2021
1.3-1	28 FEB 06	3.2-4	21 APR 2022	1.10-4	01 JAN 01
1.3-2	01 JAN 01	3.2-5	01 JAN 01	1.11-1	25 MAR 2021
1.4-1	04 JAN 18	3.3-1	28 MAR 19	1.11-2	20 AUG 15
1.5-1	08 OCT 2020	3.3-2	28 MAR 19	1.12-1	01 JAN 01
1.6-1	25 MAR 2021	3.4-1	09 SEPT 2021	1.12-2	01 JAN 01
1.6-2	24 FEB 2022	3.4-2	01 JAN 01	1.12-3	01 JAN 01
1.6-3	25 MAR 2021	3.5-1	28 MAR 19	1.12-4	01 JAN 01
1.6-4	25 MAR 2021	3.5-2	06 FEB 14	1.13-1	01 JAN 01
1.7-1	23 APR 2020	3.5-3	06 FEB 14	1.14-1	01 JAN 01
1.7-2	23 APR 2020	3.6-1	02 DEC 2020	1.14-2	01 JAN 01
1.7-3	23 APR 2020	3.6-2	02 DEC 2020	1.14-3	01 JAN 01
1.7-4	23 APR 2020	3.6-3	02 DEC 2020	1.14-4	01 JAN 01
1.8-1	04 JAN 18	3.6-4	21 AUG 14	1.14-5	01 JAN 01
<b>GEN 2</b>		3.6-5	21 AUG 14	1.14-6	01 JAN 01
2.1-1	27 AUG 09	3.6-6	21 AUG 14	1.14-7	01 JAN 01
2.1-2	18 MAY 2023	<b>GEN 4</b>		1.14-8	01 JAN 01
2.2-1	01 JAN 01	4.1-1	08 OCT 2020	<b>ENR 2</b>	
2.2-2	31 MAR 17	4.1-2	23 APR 2020	2.1-1	15 NOV 12
2.2-3	01 JAN 01	4.1-3	06 FEB 14	2.1-2	15 NOV 12
2.2-4	01 JAN 01	4.1-4	06 FEB 14	2.2-1	01 JAN 01
2.2-5	01 MAR 18	4.2-1	08 DEC 16	<b>ENR 3</b>	
2.2-6	01 JAN 01	4.2-2	08 DEC 16	3.1-1	24 FEB 2022
2.2-7	01 MAR 18			3.1-2	28 FEB 06
2.2-8	01 JAN 01				
2.2-9	01 JAN 01				

<b>PART 2-ENROUTE (ENR)</b>		<b>PART 3 – AERODROMES (AD)</b>		<b>PART 3 AERODROMES (AD)</b>	
<b>ENR 3 (CONTINUED)</b>		<b>AD 0</b>		<b>AD 2 (CONTINUED)</b>	
<b>Page</b>	<b>Date</b>	<b>Page</b>	<b>Date</b>	<b>Page</b>	<b>Date</b>
3.1-3	28 FEB 06	0.6-1	15 NOV 12	AD2-25	15NOV 12
3.1-4	24 FEB 2022	0.6-2	01 JAN 01	AD 2-26	21 APR 2022
3.2-1	11 AUG 2022	0.6-3	01 JAN 01	AD 2-27	09 SEPT 2021
3.3-1	01 JAN 01	<b>AD 1</b>		AD 2-28	09 SEPT 2021
3.4-1	01 JAN 01	1.1-1	08 OCT 20	AD 2-29	09 SEPT 2021
3.4-2	01 JAN 01	1.1-2	06 FEB 14	AD 2-30	21 APR 2022
3.5-1	09 SEPT 2021	1.2-1	04 JAN 18	AD 2-31	09 SEPT 2021
<b>ENR 4</b>		1.3-1	15 NOV 12	AD 2-32	09 SEPT 2021
4.1-1	09 SEPT 2021	1.3-2	01 JAN 01	AD 2-33	25 MAR 2021
4.2-1	01 JAN 01	1.3-3	01 JAN 01	AD 2-34	13 JAN 11
4.3-1	25 MAR 2021	<b>AD 2</b>		AD 2-35	01 JAN 01
4.4-1	01 JAN 01	AD 2-1	21 APR 2022	AD 2-36	28 FEB 06
<b>ENR 5</b>		AD 2-2	09 SEPT 2021	AD 2-37	01 JAN 01
5.1-1	01 JAN 01	AD 2-3	09 SEPT 2021	AD 2-38	15 NOV 12
5.2-1	01 JAN 01	AD 2-4	21 APR 2022	AD 2-39	01 JAN 01
5.3-1	18 MAY 2023	AD 2-5	09 SEPT 2021	AD 2-40	25 MAR 2021
5.4-1	09 SEPT 2021	AD 2-6	09 SEPT 2021	AD 2-41	09 SEPT 2021
5.5-1	01 JAN 01	AD 2-7	25 MAR 2021	AD 2-42	18 MAY 2023
5.6-1	27 AUG 09	AD 2-8	13 JAN 11	AD 2-43	18 MAY 2023
5.6-2	27 AUG 09	AD 2-9	01 JAN 01	AD 2-44	18 MAY 2023
<b>ENR 6</b>		AD 2-10	01 JAN 01	AD 2-45	26 JUL 12
6.1-1	27 AUG 09	AD 2-11	15 NOV 12	AD 2-46	26 JUL 12
6.1-2	27 AUG 09	AD 2-12	15 NOV 12	AD 2-46-2	26 JUL 12
6.2-1	01 JAN 01	AD 2-13	15 NOV 12	AD 2-47	26 JUL 12
6.3-1	01 JAN 01	AD 2-14	23 MAR 2023	AD 2-47-2	26 JUL 12
6.4-1	01 JAN 01	AD 2-15	09 SEPT 2021	AD 2-48	26 JUL 12
6.5-1	01 JAN 01	AD 2-16	18 MAY 2023	AD 2-48-2	26 JUL 12
6.6-1	01 JAN 01	AD 2-17	24 FEB 2022	AD 2-49	26 JUL 12
6.7-1	01 JAN 01	AD 2-18	09 SEPT 2021	AD 2-49-2	26 JUL 12
6.8-1	01 JAN 01	AD 2-18-2	15 NOV 12	AD 2-50	26 JUL 12
6.9-1	01 JAN 01	AD 2-19	15 NOV 12	AD 2-50-2	26 JUL 12
		AD 2-19-2	15 NOV 12	AD 2-51	26 JUL 12
		AD 2-20	15 NOV 12	AD 2-51-2	26 JUL 12
		AD 2-20-2	15 NOV 12	AD 2-52	26 JUL 12
		AD 2-21	15 NOV 12	AD 2-52-2	26 JUL 12
		AD 2-21-2	15 NOV 12	AD 2-53	26 JUL 12
		AD 2-22	15 NOV 12	AD 2-53-2	26 JUL 12
		AD 2-23	15 NOV 12	AD 2-54	26 JUL 12
		AD 2-24	15 NOV 12	AD 2-54-2	26 JUL 12

**2.2.2 Aircraft documents required (arrival/departure)**

Required by	General declaration	Passenger manifest	Cargo manifest
Immigration	1	1	Nil
Customs	1	1	1
Health	1	Nil	Nil

Notes.—

- a) *One copy of the General Declaration is endorsed and returned by Customs, signifying clearance.*
- b) *If no passengers are embarking (disembarking) and no articles are laden (unladen), no aircraft documents except copies of the General Declaration need be submitted to the above authorities.*
- c) *Passengers are required to make a declaration for currency or other negotiable monetary instruments in excess of CI \$10,000.00*

**3. Non-scheduled flights****3.1 Procedures**

3.1.1 If an operator intends to carry out a (series of) non-scheduled flight(s) in transit across, or making non-traffic stops in, the territory of the Cayman Islands, it is not necessary for the operator to obtain prior permission from the Director General of Civil Aviation however slot approval is required from the Cayman Islands Airport Authority via your nominated ground handler. Please refer to GEN 1.4-1 or AD 2-20 Local traffic regulations

3.1.2 If an operator intends to perform a (series of) non-scheduled flight(s) into the Cayman Islands for the purpose of taking on or discharging passengers, cargo or mail, it is necessary for the operator to apply to the:

Director General of Civil Aviation,  
205 Owen Roberts Drive,  
P.O. Box 10277,  
Grand Cayman KY1-1003,  
Cayman Islands,

Tel: 1 345 949 7811,  
Fax: 1 345 949 0761,  
Email: [permits@caacayman.com](mailto:permits@caacayman.com)

For permission to carry out such operations not less than twenty-four hours in advance of the intended landing. Slot approval is also required from the Cayman Islands Airport authority via your nominated ground handler. Please refer to GEN 1.4-1 or AD 2-20 Local traffic regulations.

**3.2 Documentary requirements for issuance of permit**

3.2.1 Details of the documents required to support an application for the grant of an operating permit for an aircraft can be found at: <http://www.caacayman.com/operating-permits/non-scheduled-operating-permits/>  
Email: [civil.aviation@caacayman.com](mailto:civil.aviation@caacayman.com)  
Website: [www.caacayman.com](http://www.caacayman.com)

3.2.2 Fees for operating permits will be invoiced by and are payable to the CAACI separate and apart from airport charges.

3.2.3 Subsequent to grant of operating permit, the operator should contact the Cayman Islands Airports Authority to obtain approval for landing times.

### ***3.2 Documentary requirements for clearance of aircraft***

3.2.1 Same requirements as for scheduled flights.

## **4. Private flights**

### ***4.1 Advance notification of arrival***

All flights with the exception of local based general aviation aircraft operating at Owen Roberts International Airport require slot approval. Non-scheduled operators can submit slots through their nominated handling agent.

- 4.1.1 Aircraft operators are required to have made prior arrangements for ground handling with a service provider based at Owen Roberts International airport. This includes diversion events, however nothing in this procedure shall prevent an aircraft that has declared an emergency from landing.
- 4.1.2 Out of hours operations are restricted to Medevacs and delayed commercial air transport operators up to 23:59 LST and have a mandatory requirement to obtain prior approval before operation from [aocc@caymanairports.com](mailto:aocc@caymanairports.com)
- 4.1.3 All flights must have an approved flight plan.
- 4.1.4 Advance notification of arrival MWCB. Aircraft wishing to operate at Charles Kirkconnell International Airport must have prior approval from the Airport Manager before operation. Please email [miguel.martin@caymanairports.com](mailto:miguel.martin@caymanairports.com), [AOC@ caymanairports.com](mailto:AOC@ caymanairports.com), and [CKIAOps@caymanairports.com](mailto:CKIAOps@caymanairports.com) for flight approvals.

### ***4.2 Documentary requirements for clearance of aircraft***

4.2.1 No documents, in addition to those mentioned under 2.2.2 above, are required in the case of an aircraft remaining within the Cayman Islands for less than 30 days.

## **5. Public health measures applied to aircraft**

5.1 No public health measures are required to be carried out in respect of aircraft entering the Cayman Islands, with the exception of passengers who are coming directly from an area infected with cholera, yellow fever or smallpox; they are required to present vaccination certificates.

5.2 Aircraft arriving from outside the Cayman Islands may land at any international aerodrome in the Cayman Islands provided that the aircraft has been dissection approximately thirty minutes before arrival at the aerodrome. This action must be properly recorded in the Health Section of the General Declaration. If spraying of the aircraft is to be carried out on the ground, passengers and crew are permitted to disembark beforehand.

**ENR 5.3 OTHER ACTIVITIES OF A DANGEROUS NATURE AND OTHER POTENTIAL HAZARDS****ENR 5.3.1 OTHER ACTIVITIES OF A DANGEROUS NATURE**

<b>OBST ID/Designation</b>	<b>OBS TYPE</b>	<b>OBST COORDINATES</b>	<b>ELEV/HGT</b>	<b>OBST LGT Type/Color</b>	<b>Remarks</b>
<b>1</b>	<b>2</b>	<b>3</b>	<b>4</b>	<b>5</b>	<b>6</b>
<b>Cruise Ships operating in the Vicinity of Georgetown harbour</b>	<b>Cruise Ship</b>	Anch #1 19 17.88N / 081 23.2W Anch #2 19 18.183N/ 081 23.309W Anch #3 19 18.458N/ 081 23.463W Anch #4 19 17.639N/ 081 23.306W  Approx. 2NM and 280 degrees from the ARP	<b>Up to 75m AMSL</b>	<b>Not Lit</b>	<b>N/A</b>

11, Chapter 2 and ICAO Annex 14, Volume I and II, Chapter 2. Specifications for determination and reporting of WGS-84 coordinates are given in ICAO Annex 11, Chapter 2 and in ICAO Annex 14, Volumes I and II, Chapter 2.

#### 4. Aircraft nationality and registration marks

The nationality mark for aircraft registered in the Cayman Islands are the letters VP-C. The nationality mark is followed by a registration mark consisting of 2 letters, e.g. VP-CAA.

#### 5. Public holidays 2023

<b>Date</b>	<b>Holiday</b>
<b>Monday</b> , 2 January	New Year's Day
Monday, 23 January	National Heroes' Day
Wednesday, 22 February	Ash Wednesday
Friday, 7 April	Good Friday
Monday, 10 April	Easter Monday
Monday, 8 May	HRM King Charles III Coronation
Monday, 15 May	Discovery Day
Monday, 3 July	Constitution Day
Monday, 12 November	Remembrance Day
Monday, 25 December	Christmas Day
Tuesday, 26 December	Boxing Day

*Note.— Some administrative services may not be available and banks and other institutions may not be open during public holidays.*



---

**MWCB AD 2.23 ADDITIONAL INFORMATION****1. Bird concentration in the vicinity of the airport**

1.1 Intense activity of varied bird species associated with a bird sanctuary (located on the south side of RWY 09) takes place daily. Height varies from 0 – 2000 ft AGL. Due to roosting and feeding patterns, the risk significantly increase during the periods of dawn and dusk and flights during these times should be avoided.

1.2 As far as practicable, Brac tower will inform pilots of this bird activity. Pilots of aircraft are advised, where the design limitations of aircraft installations permit, to operate landing lights in-flight, within the terminal area and during take-off, approach-to-land and climb and descent procedures.

1.3 Based on knowledge of the bird problem and ongoing mitigation methods it is recommended that all flight operations be limited to the published operational hours of the airport. **Aircraft taking off and landing before sunrise and after sunset should be discouraged.**

**2. Reporting of bird strike****2.1 General**

2.1.1 In order to accurately assess and mitigate the bird strike threat within The Cayman Islands, the Civil Aviation Authority requires comprehensive statistics of bird strike events. All pilots flying within the Charles Kirkconnell CTR are therefore requested to report to the Civil Aviation Authority all cases of bird strike or incidents where damage has occurred to the aircraft. In the case of no damage from a confirmed bird strike a report should be made to Brac Tower or the CIAA Safety Office.

**2.2 Reporting**

2.2.1 To facilitate the reporting of incidents, a Bird Strike Reporting Form is available from the following link: <https://www.caacayman.com/wp-content/uploads/forms/Occurrence%20Report%20Form%20Bird%20strikes.pdf>. In connection with incidents on or near an aerodrome, pilots are requested to collect the bird, or much of the remnants as possible, and call 345-244-5835 for assistance. In the event of a bird strike, pilots are requested to file a report and forward it to:

Director General of Civil Aviation  
Unit 2 Cayman Grand Harbour  
P.O. Box 10277  
Grand Cayman KY1-1003  
Cayman Islands

TEL: 345 949 7811  
FAX: 345 949 0761  
EMAIL: [mor@caacayman.com](mailto:mor@caacayman.com)  
Website: [www.caacayman.com](http://www.caacayman.com)

2.2.2 Any supplementary information on the circumstances under which the incident took place should also be included.

AERODROME  
CHART - ICAO

ARP 194113.14N 0795258.10W

AD ELEVATION 4.8FT

CHARLES KIRKCONNELL INT'L- MWCBC  
Cayman Brac, Cayman Islands

<b>GUND</b> (Geoid Undulation) = -58FT The height of the Geoid (MSL) above the Reference Ellipsoid (WGS84) at the stated position	
BEARINGS ARE MAGNETIC ELEVATIONS AND HEIGHTS ARE IN FEET	
ELEVATIONS IN FEET AMSL	192
HEIGHTS IN FEET ABOVE AD	(68)

**NOTE**

1. Flights below 1500FT, within 2000FT of the coastline are prohibited except final descent for landing.  
Restriction only for jet aircraft with low bypass ratio engines.
2. The threshold/rwy end lights are raised 1FT above the rwy surface.

RUNWAY/TAXIWAY/APRON PHYSICAL CHARACTERISTICS		
APRON/RWY	SURFACE	BEARING STRENGTH
RWY 09/27	Asphalt	44 F/A/W/T
TAXIWAY A	Asphalt	77 F/A/W/T
APRON	Asphalt and Concrete	72 F/A/W/T

DECLARED DISTANCES (metres)				
	TORA	TODA	ASDA	LDA
RWY 09	1829	1979	1829	1829
RWY 27	1829	1979	1829	1829

STAND	COORDINATE	Elevation AMSL(ft)
1A	194121.38N 0795248.00W	13.6
1	194121.62N 0795247.48W	13.8
1B	194121.46N 0795247.06W	13.6
2A	194121.56N 0795246.05W	13.5
2	194121.79N 0795245.54W	13.7
2B	194121.64N 0795245.11W	13.6

VAR 6.40°W - 2022  
N  
Annual Rate of Change 0.12°W

CHANGE: Fire service road added. Remote tower and anemometers also added.



AERODROME  
CHART - ICAO

ARP 191734.00N 0812127.97W

AD ELEVATION 9.5FT

OWEN ROBERTS INT'L- MWCR  
Grand Cayman, Cayman Islands

GUND (Geoid Undulation) = -48FT The height of the Geoid (MSL) above the Reference Ellipsoid (WGS84) at the stated position	
BEARINGS ARE MAGNETIC ELEVATIONS AND HEIGHTS ARE IN FEET	
ELEVATIONS IN FEET AMSL	192
HEIGHTS IN FEET ABOVE AD	(68)

RUNWAY/TAXIWAY/APRON PHYSICAL CHARACTERISTICS		
APRON/RWY	SURFACE	BEARING STRENGTH
RWY 08/26	Asphalt Grooved	84/F/C/X/T
MAIN APRON	Asphalt and Concrete	Stands 1-8, 43/F/B/W/T
MAIN APRON	Asphalt and Concrete	Stands 9-14, 67/R/B/W/T
TAXIWAY A	Asphalt	111/F/D/X/T
TAXIWAY B	Asphalt	111/F/D/X/T
TAXIWAY C	Asphalt	85/F/A/W/T
TAXIWAY D	Asphalt	78/F/A/W/T
TAXIWAY E	Asphalt	30/F/A/W/T
TAXIWAY F	Asphalt	35/F/A/W/T
TAXIWAY G	Asphalt	111/F/D/X/T
TAXIWAY H	Asphalt	South of stands 1-8, 30/F/A/W/T
TAXIWAY H	Asphalt	South of stands 9-14, 67/R/B/W/T

DECLARED DISTANCES (metres)					
RWY	TORA	TODA	ASDA	LDA	THR Displacement
08	2275	2549	2275	2010	264.6
26	2134	2284	2134	2010	123.5

- NOTES
1. Aircraft shall not make final turn over George Town for landing Rwy 08.
  2. Flights below 1500FT prohibited except final descent for landing.
  3. The Threshold RWY and lights are raised 1FT above RWY surface.

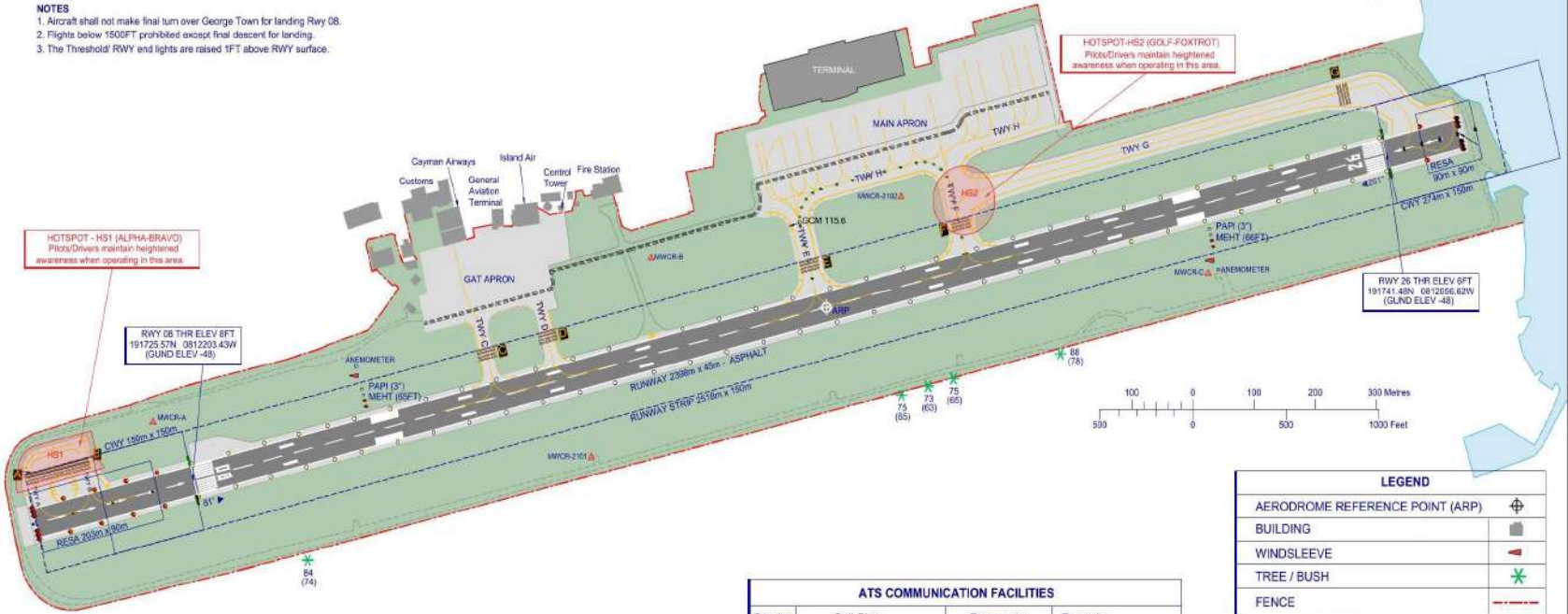

LIGHTING	
THR 08/26	Green Wing Bars
RWY 08/26	LIH White Edge, Threshold Lights Green & End Lights Red
RWY 08	PAPI-L (3")
RWY 26	PAPI-L (3")
TWY A, B, C, D, E, F, G & H	Edge Lights
TWY E, H & F	Centreline Inset Lights

ATS COMMUNICATION FACILITIES			
Service	Call Sign	Frequency	Remarks
APP	CAYMAN APPROACH	120.200 MHz	Primary frequency
		121.500 MHz	Emergency frequency
TWR	OWEN ROBERTS TOWER	118.000 MHz	Primary frequency
		121.900 MHz	Secondary frequency
ATIS		132.350 MHz	Primary frequency

LEGEND	
AERODROME REFERENCE POINT (ARP)	⊕
BUILDING	■
WINDSLEEVE	▬
TREE / BUSH	✱
FENCE	—+—+—+—+—
RWY END LIGHTS	■ ■ ■ ■ ■
RWY THR WING BAR LIGHTS	■ ■ ■ ■ ■
PAPI LIGHTS	□ □ □ □
TAXIWAY CENTRELINE LIGHTS	● ● ● ● ●
ATC SERVICE BOUNDARY	---+---
SURVEY CONTROL STATIONS	⚠

CHANGE: Runway strip length reduced at 08 End due to fence restriction. Magnetic declination revised.



AIRCRAFT PARKING/ DOCKING  
CHART - ICAO

ARP 191734.00N 0812127.97W

APRON ELEVATION 9.5FT

OWEN ROBERTS INT'L- MWCR  
Grand Cayman, Cayman Islands

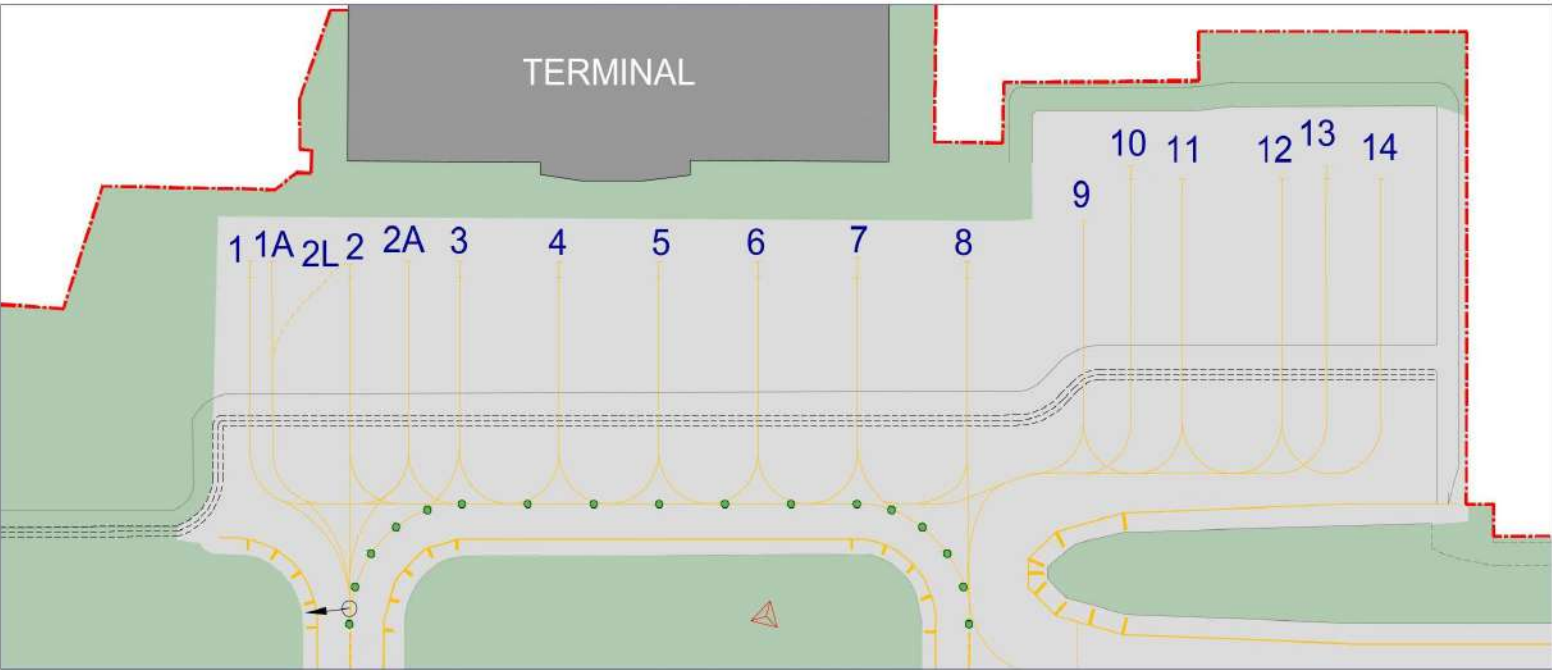

STAND	COORDINATES		Elevation AMSL(ft)
1	191741.75N	0812131.88W	7.90
1A	191742.02N	0812131.63W	8.12
2	191742.07N	0812130.53W	8.19
2A	191742.46N	0812129.80W	8.11
2L	191742.24N	0812130.64W	8.26
3	191742.43N	0812129.04W	7.86
4	191742.75N	0812127.70W	7.57
5	191743.07N	0812126.35W	7.35
6	191743.39N	0812125.00W	7.13
7	191743.70N	0812123.66W	6.99
8	191744.06N	0812122.17W	6.73
9	191745.11N	0812120.78W	6.18
10	191745.93N	0812120.30W	6.50
11	191745.94N	0812119.56W	6.45
12	191746.26N	0812118.22W	6.44
13	191746.56N	0812117.66W	6.55
14	191746.58N	0812116.87W	6.47

ATS COMMUNICATION FACILITIES			
Service	Call Sign	Frequency	Remarks
APP	CAYMAN APPROACH	120.200 MHz	Primary frequency
		121.500 MHz	Emergency frequency
TWR	OWEN ROBERTS TOWER	118.000 MHz	Primary frequency
		121.900 MHz	Secondary frequency
ATIS		132.350 MHz	Primary frequency

LEGEND	
ATC SERVICE BOUNDARY	

TAXIWAY/APRON PHYSICAL CHARACTERISTICS		
APRON/RWY	SURFACE	BEARING STRENGTH
MAIN APRON	Asphalt and Concrete	Stands 1-8, 43/F/B/W/T
MAIN APRON	Asphalt and Concrete	Stands 9-14, 67/R/B/W/T

MWCR AD 2-44 AERODROME OBSTACLE CHART – ICAO (TYPE A)

